



**HABULUS
GROUPS**

HABULUS 
NEST



**HABULUS
STRUCTURES**



Specifications

FOUNDATION & STRUCTURE

RCC Framed structure.

WALLA & FINISHINGS

External walls with 6" solid concrete blocks and internal walls with 4" solid concrete blocks

PLASTERING

Double coat sponge finish for external walls and neeru finish for internal walls.

DOORS

Main door with teak wood frame and others non-teak wood frame with commercial flush shutters/molded doors

WINDOWS

Aluminum 2 or 3 track with glass panels and with MS safety grills

FLOORING

Vitrified tiles in Hall & Dining. Others ceramic tiles. Ceramic tiles for Toilet and wash. Cement flooring in drive ways and parking.

ELECTRICAL

Concealed copper wiring and modular switches of standard equivalent.

PAINTING

Internal walls and ceiling Altech with OBD. External walls cement finish all doors and windows with Enamel paint

KITCHEN

Black Granite Cooking platform, 2 heights ceramic tiles dado, built in stainless steel sink and provision for exhaust fan.

TOILETS

Ceramic Glazed files dado up to 7 height with standard CP fittings CERA or ESS or equivalent.

WATER SUPPLY

Adequate usage of a water supply through bore well and overhead tanks,

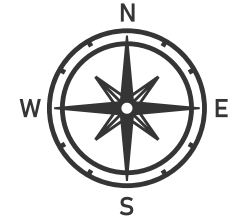

TYPICAL FLOOR PLAN

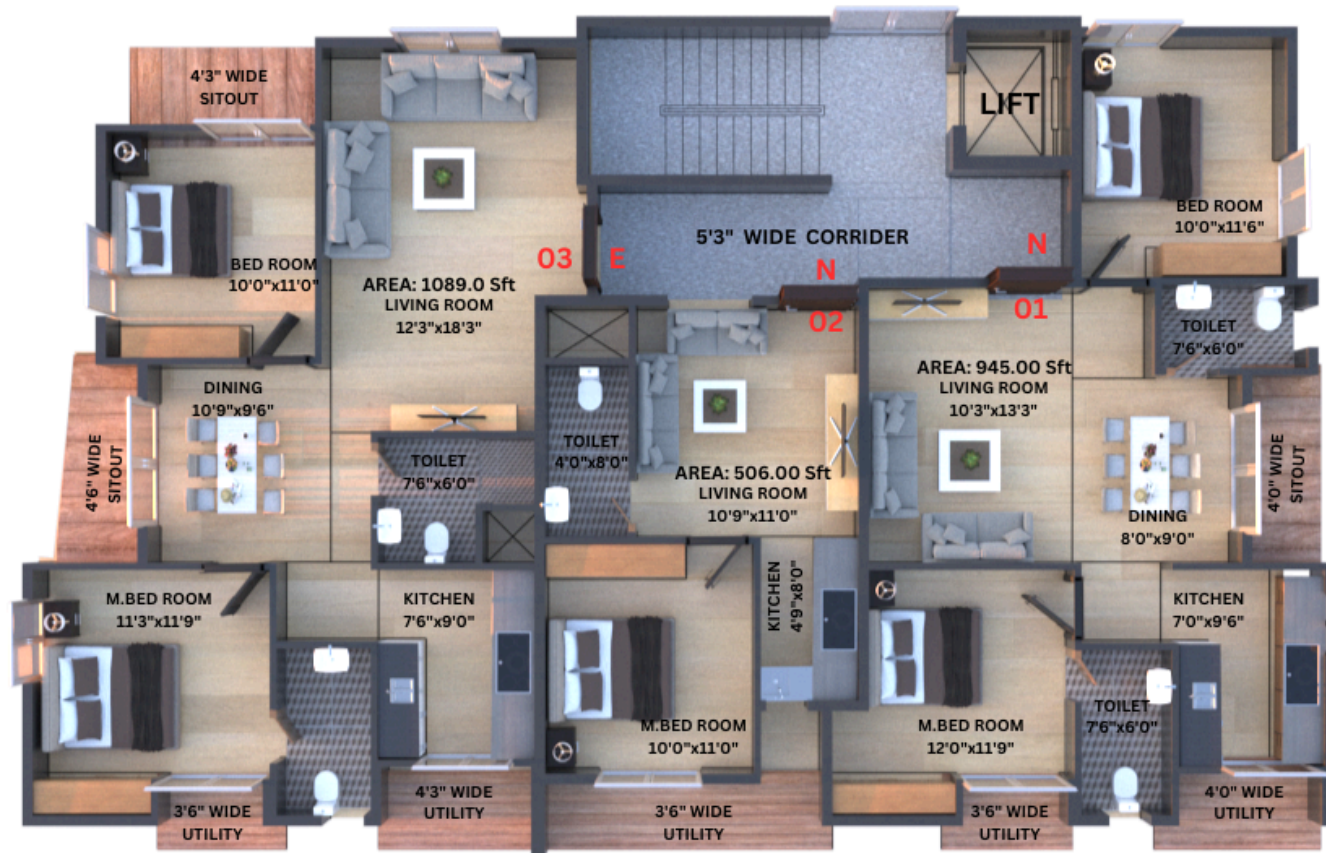

ROAD



AMENITIES



CCTV Camera



Lift



24x7 Security



Power Backup

HABULUS NEST

